

KENAN
LABS

WILSON
LIBRARY

VIEW LOOKING NORTH

Site Analysis, Comparisons, and Recommendation for
THE SONJA HAYNES STONE BLACK CULTURAL CENTER

CLIENTELE CONCLUSION B:

THIS IS THE PREFERRED SITE.

THIS IS A PRESTIGIOUS SITE AND IS ACCESSIBLE FROM THE CENTER
OF STUDENT ACTIVITIES.

THIS SITE CAN PHYSICALLY ACCOMMODATE THE BCC.

ARCHITECT'S RECOMMENDATION

SITE C IS RECOMMENDED.

THE EXPLORATION OF SEVERAL OPTIONAL EXTERIOR
ARCHITECTURAL DESIGNS. EXTERIOR ARCHITECTURAL DESIGNS SHOULD
BE DIRECTED TOWARDS A BUILDING AT THIS SITE.

Site Analysis, Comparisons, and Recommendation for
THE SONJA HAYNES STONE BLACK CULTURAL CENTER

Student Union, Book Store, and Libraries gives this site high points on the ratings scale for its positive adjacencies.

The only parking nearby or adjacent to the site is the existing permit parking. This small parking lot is in front of the site and will accommodate approximately 17 cars. This is insufficient as is and could not accommodate the BCC programmed parking needs. However, parking problems are not unique for this building relative to other buildings on campus.

This site has one street side that is accessible for the drop-off and pick-up of visitors. Traffic congestion and poor sight line are of concern. There is a traffic signal light to help. The students are primarily concerned not so much with vehicular traffic (the designer of the building can find solutions); rather, they are concerned with walking traffic from the "center of student activity" and "main campus perception".

Putting a building here would reflect a serious commitment from the University to its students and their awareness of Black Culture.

A building on this site would not result in the loss of a view to a building (at least not in the summer months) other than to appreciate the trees. A building here would not block sunlight and block or limit access to the adjacent building to an appreciable extent.

This site has a great southern exposure. An exciting entrance from South Road would give all parties a sense of pride. A front entrance leading from the Quad adjacent to the entrance of Wilson Library would be accommodating to student traffic.

This site allows the opportunities for development of an elevated walkway that extends off the West walkway (cornered by Venable Hall, Dey and the NW corner of this site) and extends along the West side adjunct to the steps and across/overhead South Road to an elevator and stairs (on each side of South Road). It would be accommodating to the disabled and all pedestrians from the heavy traffic of South Road. This elevated walkway could also be developed into an overhead plaza that would, in addition to avoiding traffic, create a "people place" to view the Bell Tower, watch the traffic pass below (with protective planting barriers) and to view and enter the new Sonja Haynes Stone Black Cultural Center. Visitor drop-off/pickup would still be at ground level below (under the plaza). A separate service entrance would also be provided.

The students of the B.C.C. strongly prefer this site. This is the BCC's choice as a location for the new Sonja

Site Analysis, Comparisons, and Recommendation for
THE SONJA HAYNES STONE BLACK CULTURAL CENTER

NARRATIVE:

SITE B. " ADJACENT WILSON LIBRARY"
Description:

This site is between Wilson Library and the Venable Hall, in front of the Dey Hall. It is surrounded by buildings on the North, East, and West. The South of the site fronts a small parking lot and South Road. The site has a gentle slope down to the South.

There are a few trees scattered around the site with a heavy concentration of trees to the south of the site. This is a very buildable site because of its topography. There is a concern for several underground utility lines and possibility of shoring to protect the existing adjacent buildings' foundations. Several safety precautions would be necessary during construction to protect the existing walkway or to detour traffic. Rectangular in shape, the site is approximately 192 feet wide (along South Road) and 264 feet deep.

This site is in a good location, situated close to central campus, and along a well traveled student pedestrian route. The site is large enough to accommodate the new BCC building's program requirements and to allow space for future expansion. The buildable area would accommodate programmed requirements for large space capabilities.

There is a high volume of student pedestrian traffic in this area. A building at this site would offer a high potential for connecting existing student pedestrian paths. There are several advantages of providing a means for circulation through the Sonja Haynes Stone Black Cultural Center building at this site. Existing circulation is already through this site. There are several heavily traveled side walks though the site and along South Road. Providing architectural features along to the existing paths in order to attract use of the BCC by passer-by pedestrian traffic is achievable.

This is an attractive site for a building and is one of the very few remaining on campus. It would serve well as the new home for the Sonja Haynes Stone Black Cultural Center.

This site has several interesting buildings to look out at: the Bell Tower, and good long views down Kenan Stadium Drive.

Careful considerations should made to develop the "free standing" appearance of the new building.

Hardly any adjacent elements to this site can be considered as negative. Being in close proximity to the

Site Analysis, Comparisons, and Recommendation for
THE SONJA HAYNES STONE BLACK CULTURAL CENTER

Haynes Stone Black Cultural Center.

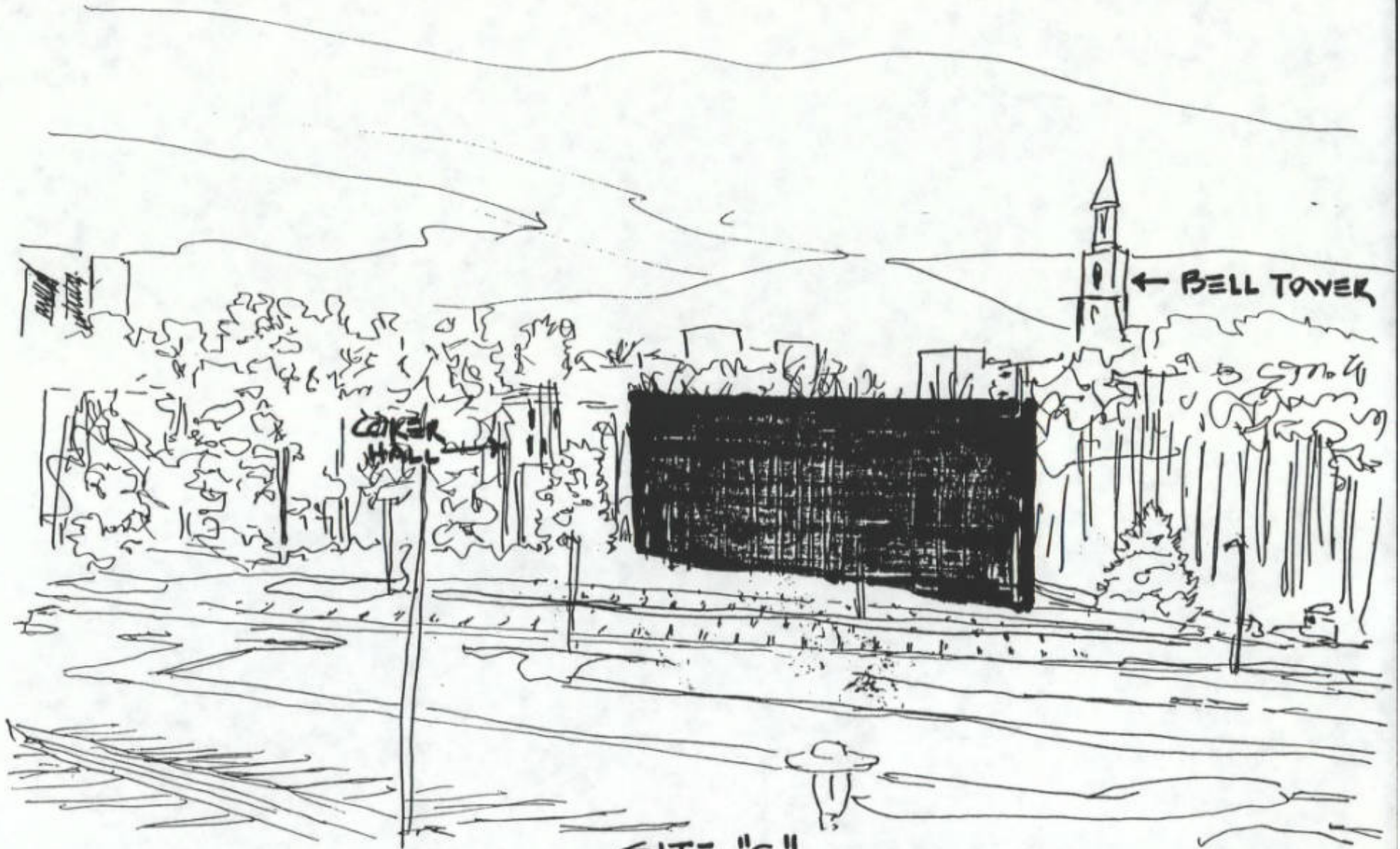

SITE "C"
LOOKING TOWARDS SITE
FROM MEMORIAL HOSPITAL

Site Analysis, Comparisons, and Recommendation for
THE SONJA HAYNES STONE BLACK CULTURAL CENTER

CLIENTELE CONCLUSION C:

THIS IS NOT THE PREFERRED SITE.

THIS IS NOT PERCEIVED AS A PRESTIGIOUS SITE

THIS IS NOT PERCEIVED AS BEING ACCESSIBLE FROM THE
CENTER OF STUDENT ACTIVITIES.

THIS SITE CAN PHYSICALLY ACCOMMODATE THE BCC, HOWEVER,
SITE PREPARATION COST AND/OR BUILDING STRUCTURAL
ACCOMMODATIONS COST WOULD BE RELATIVELY HIGHER THAN FOR THE
OTHER SITES.

ARCHITECT'S RECOMMENDATION

THIS SITE SHOULD BE CONSIDERED ONLY AS AN ALTERNATIVE TO
SITE C FOR THE EXPLORATION OF SEVERAL OPTIONAL EXTERIOR
ARCHITECTURAL DESIGNS.

NARRATIVE C:

This site sits between the Coker building and the Bell Tower. To the south of the site is Bell Tower Parking Lot. The front of the site faces South Road. This site has a creek running down its middle. The entire site slopes steeply down to this creek from both sides. The entire site is heavily wooded. This site is roughly in the shape of two triangles; one in a deep invert; the other higher on a hill (relative to two sides). It runs approximately 288 feet along the street common with the Bell Tower and 216 feet along South Road and coming to a point back at the Bell Tower Parking Lot along a Stadium Drive to the East. The high side is bordered by the Coker building and the parking lot.

This site is, situated not too far from central campus, and along a well traveled student pedestrian route. However, The BCC Advisory Board has not favored this site. This site is perceived as being "across" South Road and not into the center of student activities. This site is also perceived as being a "hole" from which the BCC would be difficult to be seen, and an undesirable site that no one else wants.

There is a high volume of student pedestrian traffic in this area. It would receive traffic through the site from, N. Memorial Hospital, the parking lot, Kenan Stadium, and dormitories to its South as it leads to the central campus.

The steep slopes and creek may cause some difficulties in placing a building on this site. The site work involved in placing a building here would be expensive. The entire site is below the level of South Road and Coker Hall. A large expense would be involved in bringing in fill to raise the site, if that approach is taken. If the level is not

Site Analysis, Comparisons, and Recommendation for
THE SONJA HAYNES STONE BLACK CULTURAL CENTER

raised or the building elevated, most of it would most likely be below South Road. The designer of the building should find challenging opportunities with this site and create attributes from the terrain.

The site is large enough to accommodate the new BCC building's program requirements. The buildable area would accommodate programmed requirements for large space capabilities.

This is an attractive site. It is exceptional and unique. It is one of the very few remaining natural terrain, natural foliage sites with a stream of water on campus. The students introduced the concern for Ecology in the site's analysis. Putting the BCC here would give the Sonja Haynes Stone Black Cultural Center a negative image.

A building on this site would not result in the loss of a view to the Coker or any other building (at least not in the summer months) other than to appreciate the trees. Several of the existing trees should be preserved.

Other factors such as long views to see the building, potential parking, traffic congestion, proximity to the Bell Tower and Kenan Stadium, three sided (corner) lot, interesting architectural opportunities, and solar orientation of the entrance were presented by the Architect but were not major concerns of the Joint Working Committee.

The Sonja Haynes Stone Black Cultural Center at The University of North Carolina-Chapel Hill

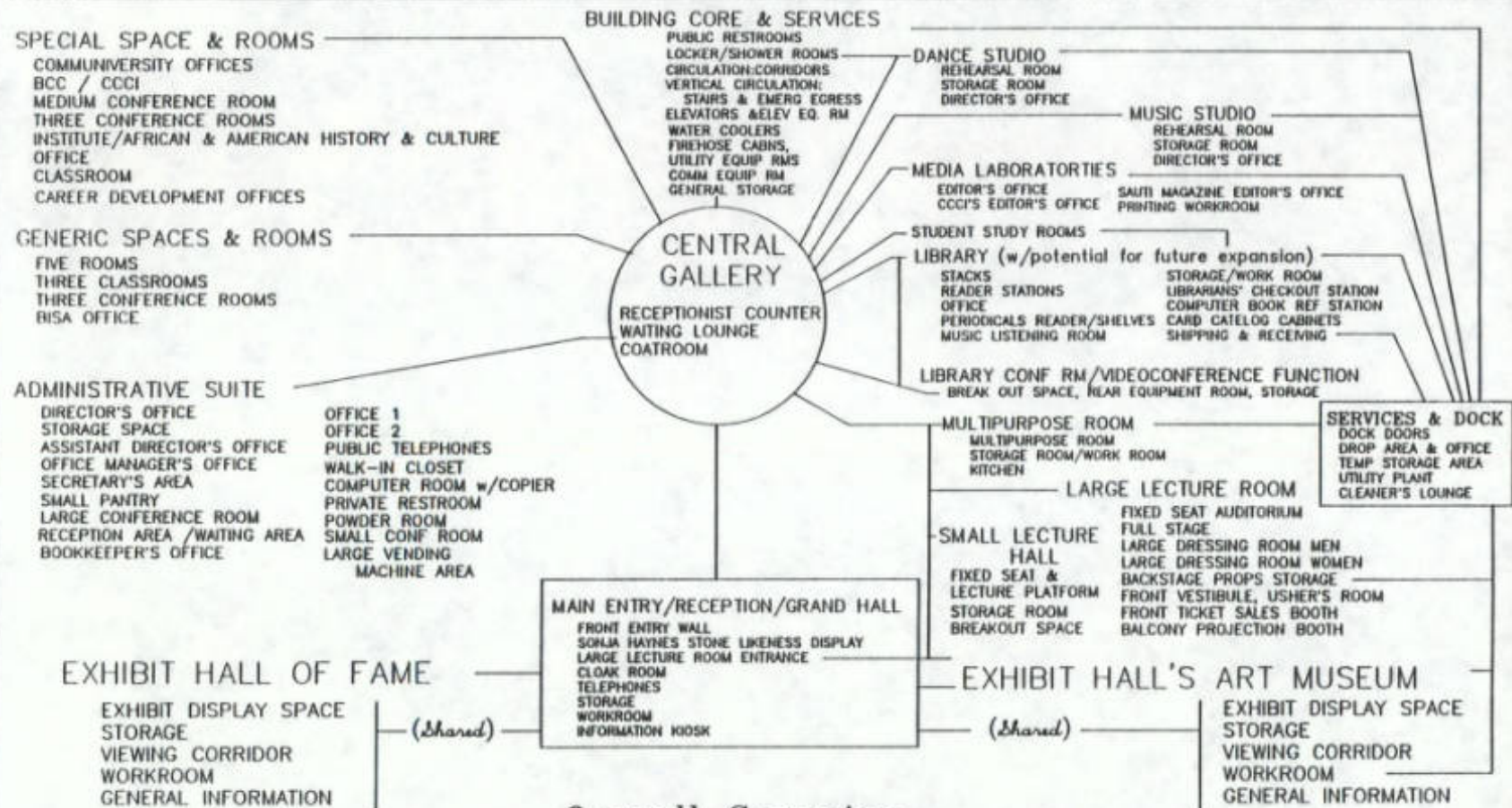

Overall Grouping
RELATIONSHIP/ADJACENCIES DIAGRAM

TOTAL BUILDING AREAS = 58,500

REVISIONS

YONGUE ARCHITECTS, PA
3203 TOWNHOM AVENUE, SUITE 121
DURHAM, NORTH CAROLINA 27713 (919)544-0145



Advance Planning & Architectural Programming
Representing The BCC's WORKING COMMITTEE
for The Sonja Haynes Stone Black Cultural Center
of The University of North Carolina at
Chapel Hill, North Carolina

Project No.	1993-001
Date	08/10/93
Drawn By	Y.A.
Check By	Y.A.
Scale	AS SHOWN
Sheet	01